

Aufbauelemente A 58 komplett

Haltekraft: **bis 80 kN**

- patentiert in DE
- ideale Ergänzung zu unseren Spannelementen der Serie MO für größere Spannhöhen
- hohe Spannsicherheit durch direkte Krafteinleitung

- Material: legierter Edelstahl
- Verbindungselement: gesenkgeschmiedet, Vergütungsstahl
- Zugstange: Festigkeitsklasse 10.9

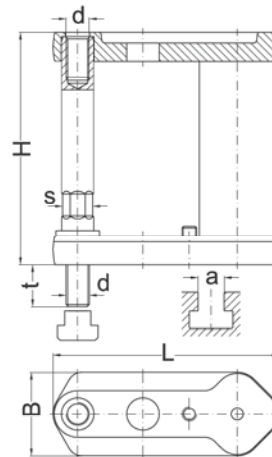

| | | | für T-Nutenführungen | | für Gewindebohrungen | | | | | | | Schlüssel | |
|-----|-----|----|-------------------------|--|-------------------------|--|----|-----|----|----|----|-----------|--|
| H | d | a | Best.-Nr. | | Best.-Nr. | | B | L | t | s | kN | Best.-Nr. | |
| 80 | M08 | 10 | 058-080-0810 | | 058-080-08 | | 48 | 135 | 16 | 16 | 16 | 622-1618 | |
| 125 | | | 058-125-0810 | | 058-125-08 | | | | | | | | |
| 160 | | | 058-160-0810 | | 058-160-08 | | | | | | | | |
| 80 | M10 | 12 | 058-080-1012 | | 058-080-10 | | 48 | 135 | 19 | 16 | 25 | 622-1618 | |
| 125 | | | 058-125-1012 | | 058-125-10 | | | | | | | | |
| 160 | | | 058-160-1012 | | 058-160-10 | | | | | | | | |
| 200 | | | 058-200-1012 | | 058-200-10 | | | | | | | | |
| 250 | | | 058-250-1012 | | 058-250-10 | | | | | | | | |
| 80 | M12 | 14 | 058-080-1214 | | 058-080-12 | | 48 | 135 | 22 | 16 | 35 | 622-1618 | |
| 125 | | | 058-125-1214 | | 058-125-12 | | | | | | | | |
| 160 | | | 058-160-1214 | | 058-160-12 | | | | | | | | |
| 200 | | | 058-200-1214 | | 058-200-12 | | | | | | | | |
| 250 | | | 058-250-1214 | | 058-250-12 | | | | | | | | |
| 80 | M14 | 16 | 058-080-1416 | | 058-080-14 | | 58 | 155 | 25 | 18 | 50 | 622-1618 | |
| 125 | | | 058-125-1416 | | 058-125-14 | | | | | | | | |
| 160 | | | 058-160-1416 | | 058-160-14 | | | | | | | | |
| 200 | | | 058-200-1416 | | 058-200-14 | | | | | | | | |
| 250 | | | 058-250-1416 | | 058-250-14 | | | | | | | | |
| 80 | M16 | 18 | 058-080-1618 | | 058-080-16 | | 58 | 155 | 29 | 18 | 70 | 622-1618 | |
| 125 | | | 058-125-1618 | | 058-125-16 | | | | | | | | |
| 160 | | | 058-160-1618 | | 058-160-16 | | | | | | | | |
| 200 | | | 058-200-1618 | | 058-200-16 | | | | | | | | |
| 250 | | | 058-250-1618 | | 058-250-16 | | | | | | | | |
| 315 | | | 058-315-1618 | | 058-315-16 | | | | | | | | |

- patentiert in DE
- ideale Ergänzung zu unseren Spannelementen der Serie MO für größere Spannhöhen
- hohe Spannsicherheit durch direkte Krafteinleitung

Aufbauelemente A 58 komplett

- **Material:** legierter Edelstahl
- **Verbindungselement:** gesenkgeschmiedet, Vergütungsstahl
- **Zugstange:** Festigkeitsklasse 10.9

Haltekraft: **bis 80 kN**

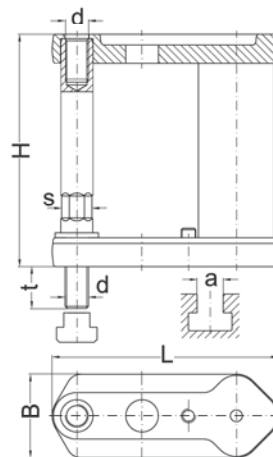

| | | | für T-Nutenführungen | | für Gewindebohrungen | | | | | | | Schlüssel | |
|-----|-----|----|-------------------------|--|-------------------------|--|----|-----|----|----|-----|-----------|--|
| H | d | a | Best.-Nr. | | Best.-Nr. | | B | L | t | s | kN | Best.-Nr. | |
| 100 | M18 | 20 | 058-100-1820 | | 058-100-18 | | 68 | 180 | 33 | 24 | 90 | 622-2427 | |
| 160 | | | 058-160-1820 | | 058-160-18 | | | | | | | | |
| 200 | | | 058-200-1820 | | 058-200-18 | | | | | | | | |
| 250 | | | 058-250-1820 | | 058-250-18 | | | | | | | | |
| 315 | | | 058-315-1820 | | 058-315-18 | | | | | | | | |
| 400 | | | 058-400-1820 | | 058-400-18 | | | | | | | | |
| 500 | | | 058-500-1820 | | 058-500-18 | | | | | | | | |
| 100 | M20 | 22 | 058-100-2022 | | 058-100-20 | | 68 | 180 | 37 | 24 | 110 | 622-2427 | |
| 160 | | | 058-160-2022 | | 058-160-20 | | | | | | | | |
| 200 | | | 058-200-2022 | | 058-200-20 | | | | | | | | |
| 250 | | | 058-250-2022 | | 058-250-20 | | | | | | | | |
| 315 | | | 058-315-2022 | | 058-315-20 | | | | | | | | |
| 400 | | | 058-400-2022 | | 058-400-20 | | | | | | | | |
| 500 | | | 058-500-2022 | | 058-500-20 | | | | | | | | |
| 100 | M22 | 24 | 058-100-2224 | | 058-100-22 | | 80 | 210 | 42 | 30 | 140 | 622-2730 | |
| 160 | | | 058-160-2224 | | 058-160-22 | | | | | | | | |
| 200 | | | 058-200-2224 | | 058-200-22 | | | | | | | | |
| 250 | | | 058-250-2224 | | 058-250-22 | | | | | | | | |
| 315 | | | 058-315-2224 | | 058-315-22 | | | | | | | | |
| 400 | | | 058-400-2224 | | 058-400-22 | | | | | | | | |
| 500 | | | 058-500-2224 | | 058-500-22 | | | | | | | | |
| 100 | M24 | 28 | 058-100-2428 | | 058-100-24 | | 80 | 210 | 47 | 30 | 160 | 622-2730 | |
| 160 | | | 058-160-2428 | | 058-160-24 | | | | | | | | |
| 200 | | | 058-200-2428 | | 058-200-24 | | | | | | | | |
| 250 | | | 058-250-2428 | | 058-250-24 | | | | | | | | |
| 315 | | | 058-315-2428 | | 058-315-24 | | | | | | | | |
| 400 | | | 058-400-2428 | | 058-400-24 | | | | | | | | |
| 500 | | | 058-500-2428 | | 058-500-24 | | | | | | | | |